

CG-22

▶ SINGLE POINT

▶ ALUMINUM
Environmentally Sealed
NTEP 1: 5,000 Class III Single Cell

CENTRAL CAROLINA SCALE, INC 5393 FARRELL ROAD SANFORD NC 27330 (919) 776-7737



CG-22 ORDER INFORMATION PRICINGⁱⁱ SUGGESTED LIST PRICE

*3 kg	\$ 130.00
*5 kg	\$ 130.00
*6 kg	\$ 130.00
*7 kg	\$ 130.00
10 kg	\$ 130.00
15 kg	\$ 130.00
20 kg	\$ 130.00
30 kg	\$ 130.00
60 kg	\$ 130.00
75 kg	\$ 130.00
100 kg	\$ 130.00

* NON-NTEP

INTERCHANGEABLE PRODUCTS

Rice Lake Weighing Systems.....	RL1521A
BLH	C2G1
Fairbanks	4900 Series
NMB	C2G1
Tedea.....	1022
Celtron.....	LPS
HBM.....	PW6K
Artech.....	61022

Main Dimensions and Accessories

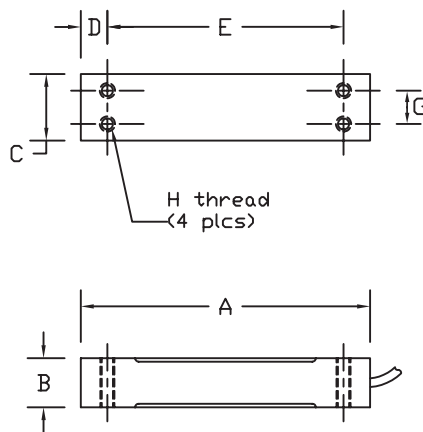

3 KG to 30KG

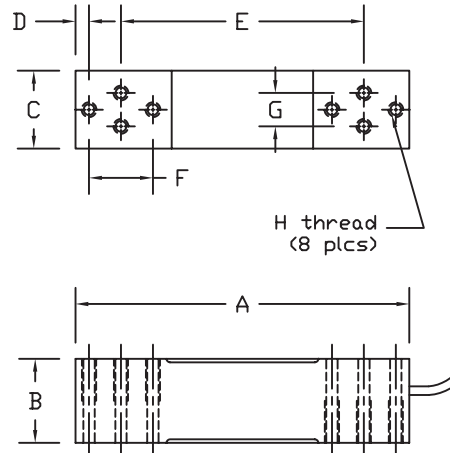

60KG to 100KG

RATED CAPACITY	DIMENSIONS										
	A	B	C	D	E	F	G	H			
3KG	2.76	0.87	0.59	0.24	2.28	-	0.28	M3			
5KG-30KG	5.12	0.87	1.18	0.47	4.17	-	0.59	M6			
60KG-100KG	5.91	1.57	1.38	0.28	4.61	0.75	0.59	M6			

▶ SPECIFICATIONS ◀

Rated Output (mV/V)	2.00 +/- 10%	Input Impedance	410 +/- 10 ohms
Nonlinearity	+/- 0.02% FS	Output Impedance	350 +/- 3 ohms
Hysteresis	+/- 0.02% FS	Insulation Resistance	5000 Megohms
Repeatability	+/- 0.02% FS	Excitation Voltage	10V AC/DC (20V Max)
Creep (30 minutes)	+/- 0.03% FS	Compensated Temperature Range	-10°C - +40°C
Zero Balance	+/- 1.00% FS	Operating Temperature Range	-20°C - +60°C
Temperature Effect on Zero	+/- 0.002% of rated output/°C	Safe Overload	150% FS
Temperature Effect on Output	+/- 0.001% of applied load/°C	Cable Length	10' Standard Cable
Cable Color Code	Input Output	Seal Type	Environmentally Sealed, IP67
	Green +Excitation White +Signal	Max Platform Size:	350 X 350 mm
	Black -Excitation Red -Signal		