

CG-23-SSW-03

▶ **THREADED HOLE
SINGLE-ENDED SHEAR BEAM**

▶ **STAINLESS STEEL**
NTEP 1:5000 Class III Multiple Cell

CENTRAL CAROLINA SCALE, INC 5393 FARRELL ROAD SANFORD NC 27330 (919) 776-7737



CG-23-SSW-XX ORDER INFORMATI^C PRICINGⁱⁱ C SUGGESTED LIST PRICE

CG-23-SSW-03-C20 3mv/v Threaded Hole 20' common cable
1K, 1.5K, 2K, 2.5K, 4K, 5Kse \$ 300.00
5K, 10K \$ 375.00

CG-23-SSW-03-T20 3mv/v Threaded Hole 20' Teflon cable
1K, 1.5K, 2K, 2.5K, 4K, 5Kse \$ 375.00
5K, 10K \$ 425.00

INTERCHANGEABLE PRODUCTS

Rice Lake Weighing Systems..... RL35083, RLH35
Sensortronics.....C20..... 65083
Celtron..... SQB HSS
Revere..... 9123
Artech.....T20..... SS30310
HBM..... H35
Fairbanks.....3-54786-1
Toledo..... TB601019-008 .5K 1KTB601016-020 1K, TB601016-008 2.5K
Toledo..... TB601017-020 4K, TB601018-008 5K

WEIGH MODULE AVAILABLE

Coti Global Sensors CG23M
Coti Global Sensors CG59M
Coti Global Sensors CG82M

Main Dimensions and Accessories

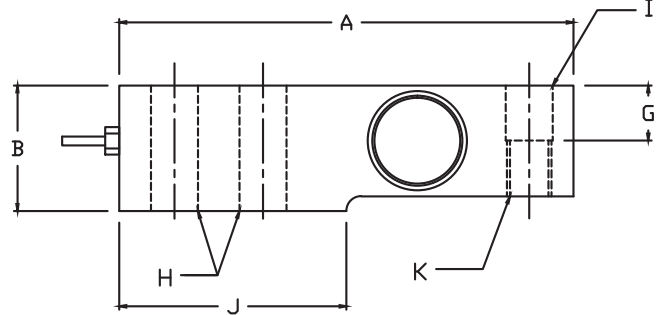
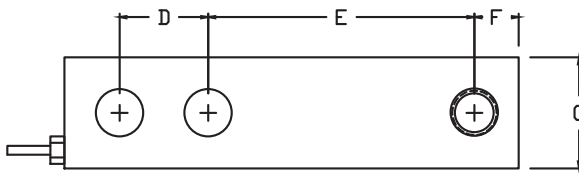

RATED CAPACITY	DIMENSIONS											
	A	B	C	D	E	F	G	H	I	J	K	
1K-5KSE	5.12	1.25	1.25	1.00	3.00	0.50	0.62	0.53	0.50	2.25	1/2 -20UNF	
5KLE-10K	6.75	1.50	1.50	1.50	3.75	0.75	0.75	0.78	0.75	3.00	3/4 -16UNF	

SPECIFICATIONS

Rated Output (mV/V)	3.00	Input Impedance	385 +/- 10 ohms
Nonlinearity	+/- 0.03% FS	Output Impedance	350 +/- 3 ohms
Hysteresis	+/- 0.02% FS	Insulation Resistance	5000 Megohms
Repeatability	+/- 0.01% FS	Excitation Voltage	10V AC/DC (20V Max)
Creep (30 minutes)	+/- 0.02% FS	Compensated Temperature Range	-10°C - +40°C
Zero Balance	+/- 1.00% FS	Operating Temperature Range	-20°C - +60°C
Temperature Effect on Zero	+/- 0.0027% of rated output/°C	Safe Overload	150% FS
Temperature Effect on Output	+/- 0.0015% of applied load/°C	Cable Length	20' Standard Cable
Cable Color Code	Input Green +Excitation Black -Excitation	Output White +Signal Red -Signal	Seal Type Welded-Seal, IP67