

CG-26S1

1.8 mV/V

▶ **ROCKER COLUMN**

▶ **STAINLESS STEEL**

Hermetically Sealed
NTEP 1:10,000 Class III Multiple Cell

CENTRAL CAROLINA SCALE, INC 5393 FARRELL ROAD SANFORD NC 27330 (919) 776-7737



CG-26S1 ORDER INFORMATION **PRICING** **SUGGESTED LIST PRICE**

50K	\$ 795.00
50K LE	\$ 795.00
100K	\$ 875.00

INTERCHANGEABLE PRODUCTS

Fairbanks.....	64166
Fairbanks.....	50K LE LCF-HR4020-2
Rice Lake Weighing Systems	50K LE RL75114

Main Dimensions and Accessories

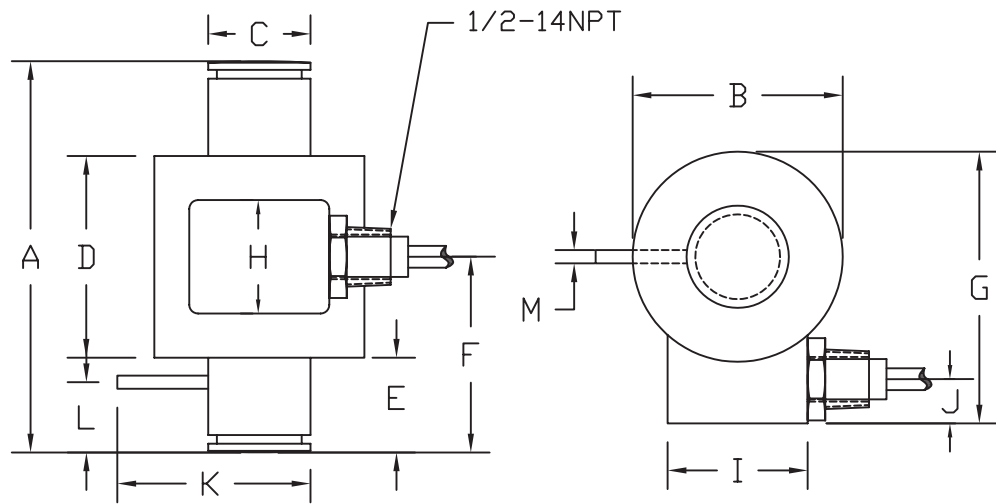

RATED CAPACITY	DIMENSIONS												
	A	B	C	D	E	F	G	H	I	J	K	L	M
50K	6.00	3.00	1.46	2.88	1.56	3.00	3.88	1.62	2.00	0.50	2.88	1.00	0.038
50KLE	7.56	3.00	1.46	2.88	2.34	3.78	3.88	1.62	2.00	0.50	2.88	1.00	0.038
100K	8.86	3.00	1.46	2.88	3.00	4.43	3.88	1.62	2.00	0.50	2.88	2.00	0.038

▶ **SPECIFICATIONS** ◀

Rated Output (mV/V)	1.8	Input Impedance	1080 +/- 10 ohms
Nonlinearity	+/- 0.03% FS	Output Impedance	1000 +/- 5 ohms
Hysteresis	+/- 0.02% FS	Insulation Resistance	5000 Megohms
Repeatability	+/- 0.01% FS	Excitation Voltage	10V AC/DC (20V Max)
Creep (30 minutes)	+/- 0.02% FS	Compensated Temperature Range	0° - 30°C
Zero Balance	+/- 1.00% FS	Operating Temperature Range	-20°C - +60°C
Temperature Effect on Zero	+/- 0.0027% of rated output/°C	Safe Overload	150% FS
Temperature Effect on Output	+/- 0.0015% of applied load/°C	Cable Length	50' Braided Shield
Cable Color Code	Input Output	Seal Type	Hermetically Sealed, IP67
	Green +Excitation White +Signal		
	Black -Excitation Red -Signal		