

CG-60610

▶ SINGLE POINT
▶ Stainless Steel

CENTRAL CAROLINA SCALE, INC 5393 FARRELL ROAD SANFORD NC 27330 (919) 776-7737



CG-60610	ORDER INFORMATION	PRICING ⁱⁱⁱ	SUGGESTED LIST PRICE
10 lb			\$ 335.00
15 lb			\$ 335.00
20 lb			\$ 335.00
25 lb			\$ 335.00

INTERCHANGEABLE PRODUCTS
Artech..... 60610

Main Dimensions and Accessories

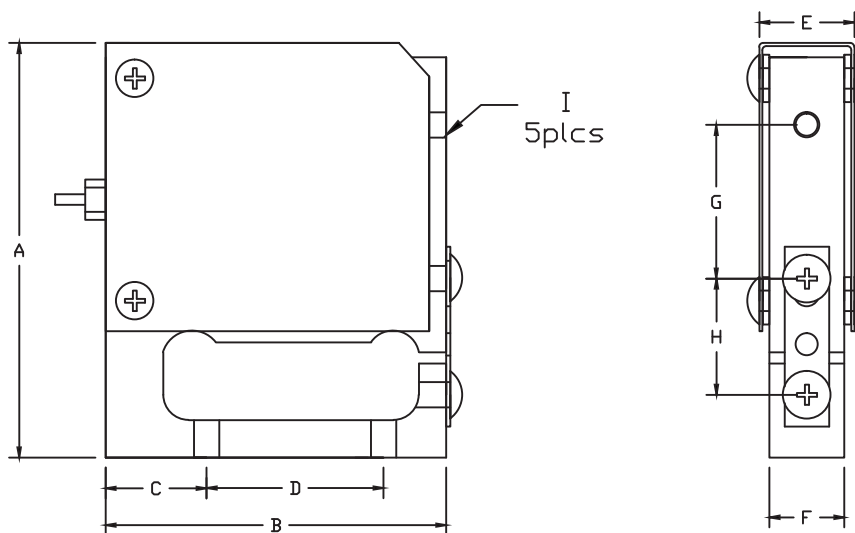

RATED CAPACITY	DIMENSIONS									
	A	B	C	D	E	F	G	H	I	
10LB-25LB	4.10	3.37	1.00	1.75	0.94	0.74	1.52	1.15	1/4-28UNF	

→ SPECIFICATIONS ←

Rated Output (mV/V)	2.00 +/- 10%	Input Impedance	385 +/- 10 ohms
Nonlinearity	+/- 0.03% FS	Output Impedance	350 +/- 3 ohms
Hysteresis	+/- 0.02% FS	Insulation Resistance	5000 Megohms
Repeatability	+/- 0.02% FS	Excitation Voltage	10V AC/DC (20V Max)
Creep (30 minutes)	+/- 0.03% FS	Compensated Temperature Range	-10°C - +40°C
Zero Balance	+/- 1.00% FS	Operating Temperature Range	-20°C - +60°C
Temperature Effect on Zero	+/- 0.002% of rated output/°C	Safe Overload	150% FS
Temperature Effect on Output	+/- 0.001% of applied load/°C	Cable Length	10' Standard Cable
Cable Color Code	Input Red +Excitation Black -Excitation	Output Green +Signal White -Signal	Seal Type Max Platform Size: Environmentally Sealed, Potted, IP67 10 - 15 lb: 6" X 6" 20 - 25 lb: 12" X 12"