

CG-65029

▶ SINGLE POINT
▶ Stainless Steel

CENTRAL CAROLINA SCALE, INC 5393 FARRELL ROAD SANFORD NC 27330 (919) 776-7737



CG-65029	ORDER INFORMATION	PRICING ⁱⁱ	SUGGESTED LIST PRICE
7 lb			\$ 250.00
15 lb			\$ 250.00
20 lb			\$ 250.00

INTERCHANGEABLE PRODUCTS
Vishay..... 65029

Main Dimensions and Accessories

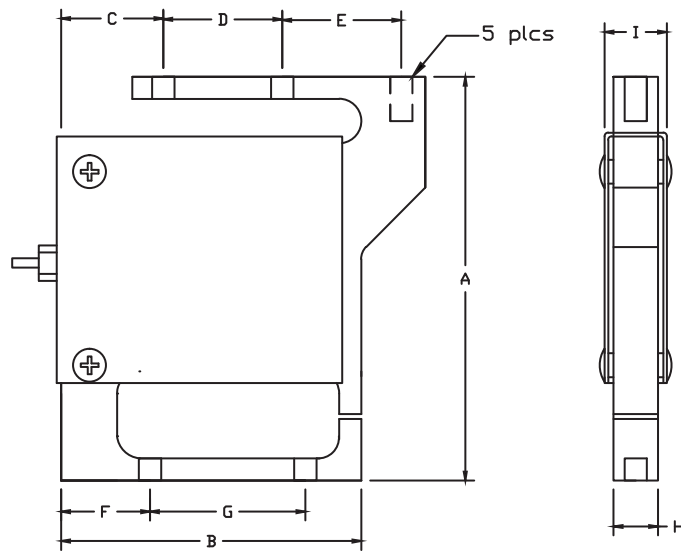

RATED CAPACITY	DIMENSIONS										
	A	B	C	D	E	F	G	H	I	J	
7LB-20LB	4.55	3.38	1.15	1.34	1.34	1.00	1.75	0.50	0.70	1/4-28UNF	

SPECIFICATIONS

Rated Output (mV/V)	1.7 +/- 10%	Input Impedance	385 +/- 10 ohms
Nonlinearity	+/- 0.03% FS	Output Impedance	350 +/- 3 ohms
Hysteresis	+/- 0.02% FS	Insulation Resistance	5000 Megohms
Repeatability	+/- 0.02% FS	Excitation Voltage	10V AC/DC (20V Max)
Creep (30 minutes)	+/- 0.03% FS	Compensated Temperature Range	-10°C - +40°C
Zero Balance	+/- 1.00% FS	Operating Temperature Range	-20°C - +60°C
Temperature Effect on Zero	+/- 0.002% of rated output/°C	Safe Overload	150% FS
Temperature Effect on Output	+/- 0.001% of applied load/°C	Cable Length	10' Standard Cable
Cable Color Code	Input Red +Excitation Black -Excitation	Output Green +Signal White -Signal	Seal Type Max Platform Size:
			Environmentally Sealed, Potted, IP67 7 - 20 lb: 6" X 10"