

CG-BLC-T

▶ **THREADED, SINGLE-ENDED BEAM**

▶ **STAINLESS STEEL**

CENTRAL CAROLINA SCALE, INC 5393 FARRELL ROAD SANFORD NC 27330 (919) 776-7737

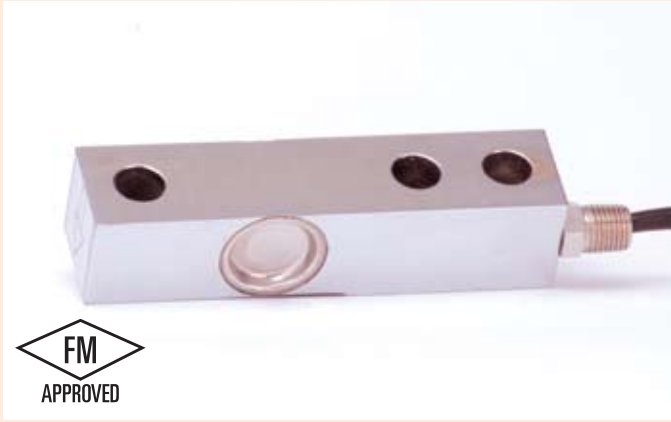

CG-BLC-T ORDER INFORMATION **PRICING** **SUGGESTED LIST PRICE**

| Without Counter Bore - Threaded | | |
|---------------------------------|------|-----------|
| CG-BLC-T | 1K | \$ 300.00 |
| CG-BLC-T | 2.5K | \$ 300.00 |
| CG-BLC-T | 4K | \$ 300.00 |
| CG-BLC-T | 5K | \$ 400.00 |
| CG-BLC-T | 10K | \$ 475.00 |

INTERCHANGEABLE PRODUCTS

| | |
|---------------------------------|------------|
| Rice Lake Weighing Systems..... | RLBLC |
| HBM..... | BLC |
| Toledo | 084759-020 |

Main Dimensions and Accessories

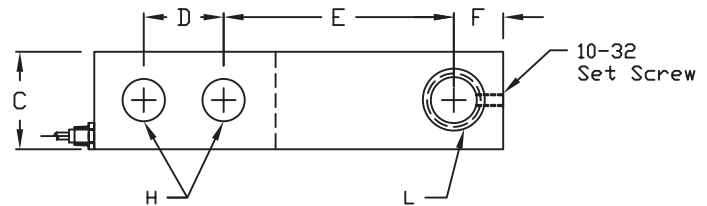
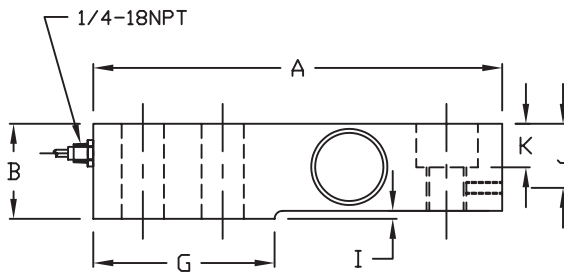

| RATED CAPACITY | DIMENSIONS | | | | | | | | | | | | |
|----------------|------------|------|------|------|------|------|------|------|-------|------|------|------|-----------|
| | A | B | C | D | E | F | G | H | I | J | K | L | M |
| 1K-4K | 5.12 | 1.19 | 1.21 | 1.00 | 3.00 | 0.60 | 2.27 | 0.52 | 0.065 | 0.80 | 0.60 | 0.53 | 1/2-20UNF |
| 5K | 6.75 | 1.44 | 1.45 | 1.50 | 3.75 | 0.75 | 3.00 | 0.78 | 0.090 | 1.00 | 0.67 | 0.78 | 3/4-16UNF |
| 10K | 6.75 | 1.69 | 1.69 | 1.50 | 3.75 | 0.75 | 3.00 | 0.78 | 0.090 | 1.30 | 0.80 | 0.78 | 3/4-16UNF |

▶ **SPECIFICATIONS** ◀

| | | | |
|------------------------------|--------------------------------------|-------------------------------|---------------------|
| Rated Output (mV/V) | 3.00 | Input Impedance | 1080 +/- 10 ohms |
| Nonlinearity | +/- 0.03% FS | Output Impedance | 1000 +/- 5 ohms |
| Hysteresis | +/- 0.03% FS | Insulation Resistance | 5000 Megohms |
| Repeatability | +/- 0.01% FS | Excitation Voltage | 10V AC/DC (20V Max) |
| Creep (30 minutes) | +/- 0.02% FS | Compensated Temperature Range | -10°C - +40°C |
| Zero Balance | +/- 1.00% FS | Operating Temperature Range | -20°C - +60°C |
| Temperature Effect on Zero | +/- 0.0027% of rated output/°C | Safe Overload | 150% FS |
| Temperature Effect on Output | +/- 0.0015% of applied load/°C | Cable Length | 20' Standard Cable |
| Cable Color Code | Input Output | Seal Type | Welded-Seal, IP67 |
| | Green +Excitation White +Signal | | |
| | Black -Excitation Red -Signal | | |