

CG-HPS

▶ SINGLE POINT

▶ STAINLESS STEEL
Low Capacity

CENTRAL CAROLINA SCALE, INC 5393 FARRELL ROAD SANFORD NC 27330 (919) 776-7737



CG-HPS ORDER INFORMATION PRICINGⁱⁱ SUGGESTED LIST PRICE

6 Kg	\$ 600.00
25 lb	\$ 600.00
50 lb	\$ 600.00
100 lb	\$ 775.00

INTERCHANGEABLE PRODUCTS

Revere..... HPS

Main Dimensions and Accessories

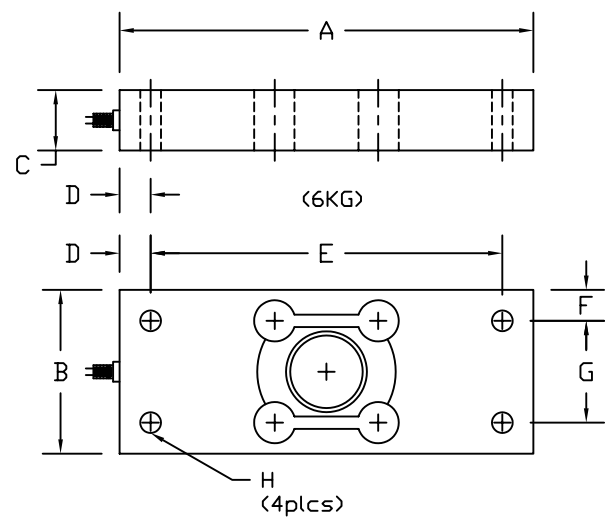
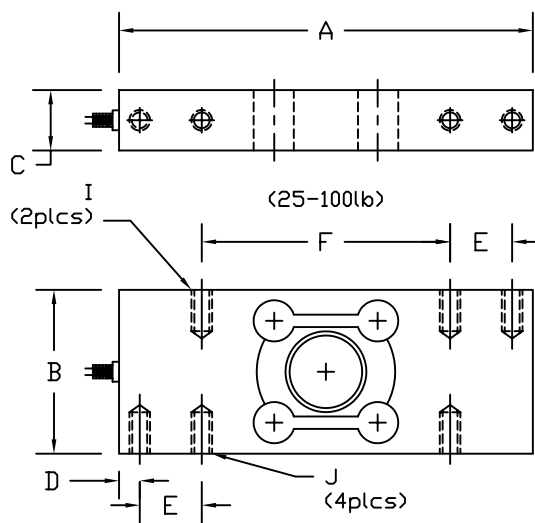

RATED CAPACITY	DIMENSIONS									
	A	B	C	D	E	F	G	H	I	J
6KG	5.00	1.98	0.73	0.37	4.25	0.37	1.25	0.25	-	-
25LB-50LB	5.00	1.98	0.73	0.25	0.75	3.00	-	-	10-24UNC X 0.35.dp	1/4-20UNC X 0.35.dp
100LB	5.00	1.98	0.94	0.25	0.75	3.00	-	-	10-24UNC X 0.35.dp	1/4-20UNC X 0.35.dp

→ SPECIFICATIONS ←

Rated Output (mV/V)	2.00 or 3.00 (KG version 2) +/- 10%	Input Impedance	385 +/- 10 ohms
Nonlinearity	+/- 0.03% FS	Output Impedance	350 +/- 3 ohms
Hysteresis	+/- 0.02% FS	Insulation Resistance	5000 Megohms
Repeatability	+/- 0.02% FS	Excitation Voltage	10V AC/DC (20V Max)
Creep (30 minutes)	+/- 0.03% FS	Compensated Temperature Range	-10°C - +40°C
Zero Balance	+/- 1.00% FS	Operating Temperature Range	-20°C - +60°C
Temperature Effect on Zero	+/- 0.002% of rated output/°C	Safe Overload	150% FS
Temperature Effect on Output	+/- 0.001% of applied load/°C	Cable Length	10' Standard Cable
Cable Color Code	Input Green +Excitation Black -Excitation	Output White +Signal Red -Signal	Seal Type Environmentally Sealed, IP67
		Max Platform Size:	254 x 254 mm