

CG-SPL

▶ SINGLE POINT

▶ ALUMINUM

CENTRAL CAROLINA SCALE, INC 5393 FARRELL ROAD SANFORD NC 27330 (919) 776-7737



CG-SPL ORDER INFORMATION **PRICING^g SUGGESTED LIST PRICE**

6 lb.	\$ 315.00
10 lb.	\$ 315.00
15 lb.	\$ 315.00
25 lb.	\$ 315.00
50 lb.	\$ 315.00
100 lb.	\$ 315.00

INTERCHANGEABLE PRODUCTS

Cardinal.....	SP-L
---------------	------

Main Dimensions and Accessories

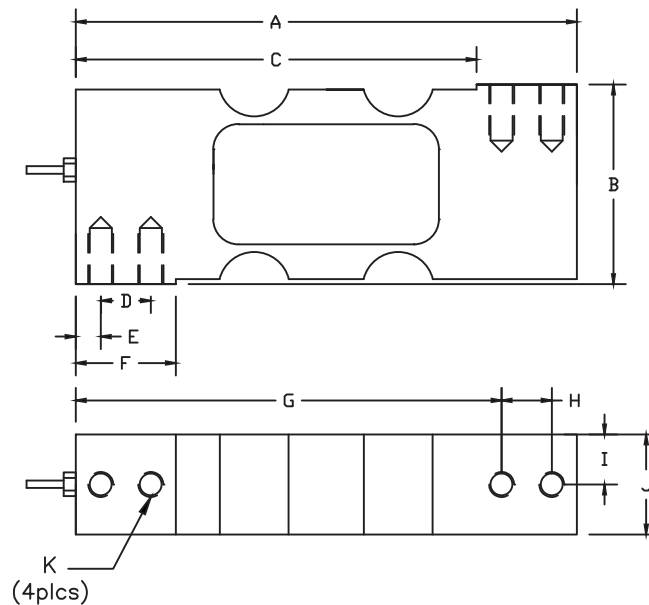

RATED CAPACITY	DIMENSIONS										
	A	B	C	D	E	F	G	H	I	J	K
6lb-100lb	5.00	1.99	4.00	0.50	0.25	1.00	4.25	0.50	0.50	1.00	1/4-28UNFX0.50dp

→ SPECIFICATIONS ←

Rated Output (mV/V)	2.00 +/- 10%	Input Impedance	410 +/- 10 ohms
Nonlinearity	+/- 0.02% FS	Output Impedance	350 +/- 3 ohms
Hysteresis	+/- 0.02% FS	Insulation Resistance	5000 Megohms
Repeatability	+/- 0.02% FS	Excitation Voltage	10V AC/DC (20V Max)
Creep (30 minutes)	+/- 0.03% FS	Compensated Temperature Range	-10°C - +40°C
Zero Balance	+/- 1.00% FS	Operating Temperature Range	-20°C - +60°C
Temperature Effect on Zero	+/- 0.002% of rated output/°C	Safe Overload	150% FS
Temperature Effect on Output	+/- 0.001% of applied load/°C	Cable Length	10' Standard Cable
Cable Color Code	Input Output	Seal Type	Environmentally Sealed, IP65
	Green +Excitation Red +Signal	Max Platform Size:	400 X 400 mm
	Black -Excitation White -Signal		