

CGSB

▶ S-BEAM

▶ ALLOY STEEL
NTEP 1:10,000 Class III, Single Cell

CENTRAL CAROLINA SCALE, INC 5393 FARRELL ROAD SANFORD NC 27330 (919) 776-7737



CGSB ORDER INFORMATION PRICING[†] SUGGESTED LIST PRICE

*25 lb, *50 lb	\$ 165.00
*100 lb, *150 lb, *200 lb	\$ 165.00
250 lb, 300 lb, 500 lb, 750 lb	\$ 165.00
1K, 1.5K, 2K, 2.5K, 3K	\$ 165.00
5K, 10K	\$ 325.00
15K	\$ 455.00
20K	\$ 685.00
*40K	\$ 955.00
*Non-NTEP	

INTERCHANGEABLE PRODUCTS

Rice Lake Weighing Systems.....	RL20001
Sensortronics.....	60001
Celtron.....	STC

WEIGH MODULE AVAILABLE

Coti Global Sensors.....	ITCM
--------------------------	------

Main Dimensions and Accessories

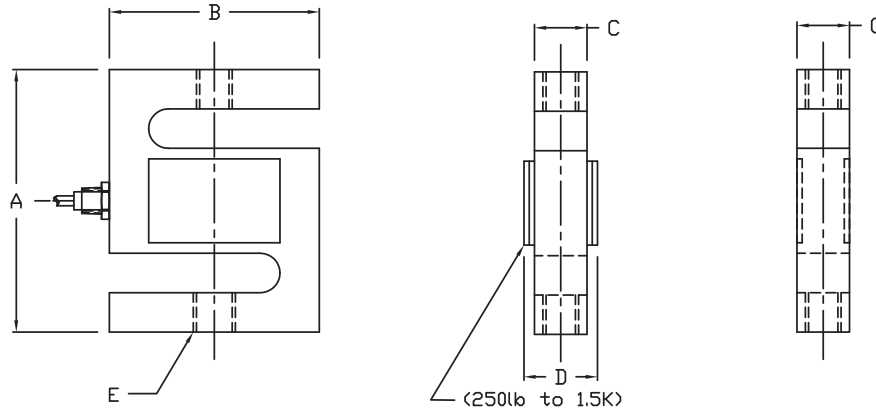

RATED CAPACITY	DIMENSIONS					
	A	B	C	D	E	
25lb-50lb	2.50	2.00	0.50	1.00	1/4-28UNF	
100lb-200lb	2.50	2.00	0.50	0.75	1/4-28UNF	
250lb-300lb	3.00	2.00	0.50	0.75	3/8-24UNF	
500lb-1.5K	3.00	2.00	0.75	1.00	1/2-20UNF	
2K-3K	3.00	2.00	1.00	-	1/2-20UNF	
5K	4.25	3.00	1.00	-	3/4-16UNF	
10K	4.75	3.50	1.00	-	3/4-16UNF	
15K	5.50	4.00	1.25	-	1-14UNF	
20K	7.00	5.00	2.00	-	1 1/4-12UNF	
40K	7.50	5.50	2.50	-	1 1/2-12UNF	

▶ SPECIFICATIONS ◀

Rated Output (mV/V)	3.00	Input Impedance	385 +/- 10 ohms
Nonlinearity	+/- 0.03% FS	Output Impedance	350 +/- 3 ohms
Hysteresis	+/- 0.02% FS	Insulation Resistance	2000 Megohms
Repeatability	+/- 0.01% FS	Excitation Voltage	10V AC/DC (20V Max)
Creep (30 minutes)	+/- 0.02% FS	Compensated Temperature Range	-10°C - +40°C
Zero Balance	+/- 1.00% FS	Operating Temperature Range	-20°C - +60°C
Temperature Effect on Zero	+/- 0.0027% of rated output/°C	Safe Overload	150% FS
Temperature Effect on Output	+/- 0.0015% of applied load/°C	Cable Length	20' Standard Cable
Cable Color Code	Input Output	Seal Type	Environmentally-Sealed, IP67
	Green +Excitation White +Signal		
	Black -Excitation Red -Signal		