

# CLS-420 Wired Version Cargo Lift Scale

FORKLIFT/PALLET JACK



## APPROVALS



## STANDARD FEATURES

### Scale Carriage

- Compatible with Class II or III forklift carriage types
- New industry standard out of level NTEP tolerance at 7 degrees pitch and roll, 3 degrees side to side
- 1 1/2 in thick front and back painted steel plates coupled by four flexures
- Top cleats are welded, pinned and bolt
- Welded centering pin
- 6 in x 20 3/4 in viewing portal allows driver a clear view of forks
- Mechanical overload stops
- Two 5,000 pound S-Beam load cells
- ABS plastic two channel iQUBE™ j-box with inclinometer completely protected by front plate
- Cal-Match™ algorithm automatically trims the scale with only a 3-Point calibration

### 420 Plus Indicator

- Six digit, 0.8 in red LED display
- Full numeric keypad for manual tare entry
- Accumulate weight function using the print key for multiple pallet loading
- Front panel calibration
- RS-232 port transmits time, date and weight for interface to PC or 10-60 VDC power supply for use on propane and electric forklifts
- Stainless steel enclosure
- Two piece top cage indicator mounting assembly with vibration mounts

### Optional Field Installed Zigbee™ Wireless

- Eliminates coiled cable from j-box to indicator
- Reinforced battery box welded onto cover plate to withstand harsh forklift environment
- On/Off switch to conserve battery life, with green LED
- Zigbee™ connection from scale to indicator
- Battery life, minimum 24 hours constant use with only 8 hours to fully charge
- Includes two lithium ion smart batteries and charger

### Factory Recommendations

- Rice Lake recommends using Zebra RW 220 or RW 420 portable thermal printer
- When installing a forklift scale on an electric forklift, static discharge protection must be installed on the forklift
- When installing a forklift scale, OSHA requires the end user to de-rate the lift capacity of the forklift
- Compatible with most Class II and Class III forklift attachments, consult factory
- Power conditioner installed when used on electric forklift scales

## SPECIFICATIONS

### Scale Capacity:

- Class II: 5,000 lb x 5 lb NTEP approved  
5,000 lb x 1 lb non type approved
- Class III: 8,000 lb x 5 lb non type approved

### Scale Power:

Supplied by indicator through coiled interface cable

### Scale Material/Finish:

Painted Mild Steel

### 420 Plus Display:

0.8 in (20 mm), 6-digit Super Red Light Emitting Diode (LED), 7-segment digits

### 420 Power - DC:

Line voltages: 10-60VDC DC input  
Power consumption: 0.75A Max Fused at 5.0A

### 420 Status Annunciators:

Designators for: center of zero, stand still, gross, net, lb, kg, tare

### 420 Operating Temperature:

Legal: 14°F to 104°F (-10°C to 40°C)  
Industrial: 14°F to 122°F (-10°C to 50°C)

### Warranty:

Two-year limited warranty

### Approval:

NTEP CC 06-074 (5,000 lb only) per H-44 at 1,000 divisions

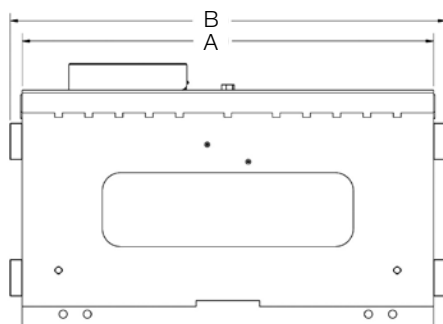
**CLS-420 Wired Version** Cargo Lift Scale

Front view

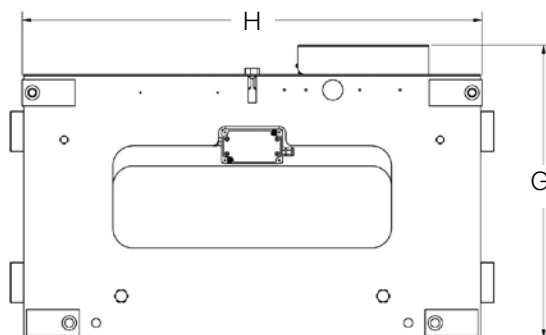

Rear view

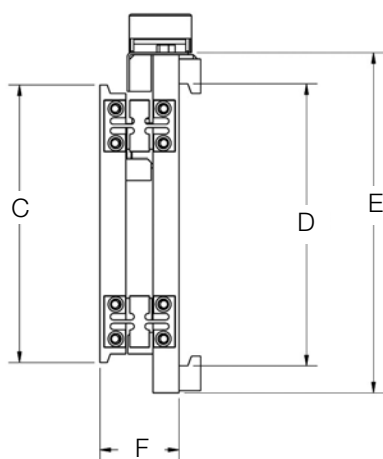

Side view

**CLS DIMENSIONS****28 in, 5000 lb**

A	28 in (711.2 mm)	E	19.50 in (495.3 mm)
B	30 in (762.2 mm)	F	4.49 in (114 mm)
C	16 in (406.4 mm)	G	21.80 in (553.7 mm)
D	16.29 in (413.8 mm)	H	28.24 in (717.3 mm)

**34 in, 5000 lb**

A	34 in (863.6 mm)	E	19.50 in (495.3 mm)
B	36 in (914.4 mm)	F	4.49 in (114 mm)
C	16 in (406.4 mm)	G	21.80 in (553.7 mm)
D	16.29 in (413.8 mm)	H	34.24 in (869.7 mm)

**38 in, 8000 lb**

A	38 in (965.2 mm)	E	24.50 in (622.3 mm)
B	40 in (1016 mm)	F	6.04 in (153.4 mm)
C	20 in (508 mm)	G	26.68 in (677.7 mm)
D	20.15 in (511.8 mm)	H	38 in (965.2 mm)

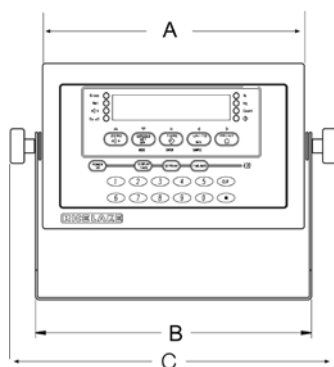

420 Plus Side view

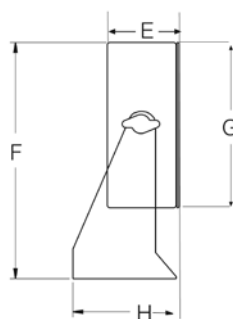
**420 PLUS DIMENSIONS**

A	9.50 in (24 mm)	F	8.57 in (217 mm)
B	10.02 in (254 mm)	G	6.00 in (152 mm)
C	11.80 in (299 mm)	H	3.25 in (82 mm)
E	3.12 in (79 mm)		3.0 in (76.2 mm)

# CLS-420 Wired Version Cargo Lift Scale

## PART NUMBER/PRICE

PART #	SIZE, CAPACITY	FORKLIFT COMPATIBILITY	WEIGHT	PRICE
<b>CLS Forklift Scale, 420 Wired Version</b>				
111033	5,000 x 5 lb NTEP approved	28 in W, Class II 16 in forklift carriage (30 in W with flexures)	524 lb	Consult
130822	5,000 x 5 lb NTEP approved	34 in W, Class II 16 in forklift carriage (36 in W with flexures)	539 lb	Consult
111038*	8,000 x 5 lb Non Legal for Trade	38 in W, Class III 20 in forklift carriage (40 in W with flexures)	1144 lb	Consult

\*Non-NTEP

## OPTIONS/ACCESSORIES

PART #	DESCRIPTION	PRICE
112986	Wireless LAN card 802.11 B/G, requires factory installation	Consult
	Bluetooth module, factory installed	Consult
98289	Wireless indicator j-box (upgrade wired to wireless)	Consult
152479	Zigbee™ wireless battery box (upgrade wired to wireless), 28 in	Consult
126534	Zigbee wireless battery box (upgrade wired to wireless), 34 in	Consult
131864	Zigbee wireless battery box (upgrade wired to wireless), 38 in	Consult
<b>Replacement Parts</b>		
96196	Custom load cell box wrench	Consult
98413	CLS 420i replacement indicator	Consult
96252	Coiled cable (j-box to indicator), black	Consult
96915	Power cable assembly with power fuse cable	Consult
130129	Power fuse cable assembly	Consult
96198	RL 20000 FLS load cell 5K 1.5 mv/v 350 ohm (for use with 121014)	Consult
121014	iQUBE™ J-box assembly, (for use with 96198), Class II	Consult
121366	iQUBE J-box assembly, (for use with 96198), Class III	Consult
125543	RL20000 FLS load cell 5K 1.5 mv/v 350 ohm (for use with 130826) with automotive quick disconnects	Consult
130826	iQUBE j-box assembly (for use with 125543), Class II with automotive quick disconnects	Consult
132960	iQUBE j-box assembly (for use with 125543), Class III with automotive quick disconnects	Consult
96343	Battery, forklift lithium ion	Consult
<b>Manuals</b>		
96483	CLS-420 installation manual	Consult
96484	CLS-420 operator card	Consult

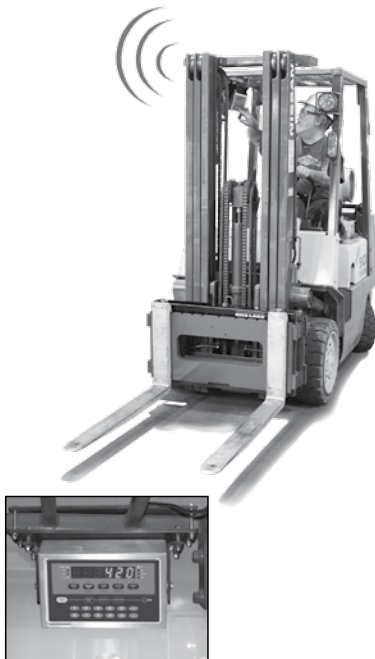
**CLS-420 Wireless Version** Cargo Lift Scale**APPROVALS****STANDARD FEATURES****Scale Carriage**

- Compatible with Class II or III forklift carriage types
- New industry standard out of level NTEP tolerance at 7 degrees pitch and roll, 3 degrees side to side
- 1 1/2 inch thick front and back painted steel plates coupled by four flexures
- Top cleats are welded, pinned and bolt
- Welded centering pin
- 6 inch x 20 3/4 inch viewing portal allows driver a clear view of forks
- Mechanical overload stops
- Two 5,000 pound S-Beam load cells
- ABS plastic two channel iQUBE™ j-box with inclinometer completely protected by front plate
- Cal-Match™ algorithm automatically trims the scale with only a 3-Point calibration

**420 Plus Indicator**

- Six digit, 0.8 inch red LED display
- Full numeric keypad for manual tare entry
- Accumulate weight function using the print key for multiple pallet loading
- Front panel calibration
- RS-232 port transmits time, date and weight for interface to PC or 10-60 VDC power supply for use on propane and electric forklifts
- Stainless steel enclosure
- Two piece top cage indicator mounting assembly with vibration mounts

**Optional Field Installed Zigbee™ Wireless**

- Eliminates coiled cable from j-box to indicator
- Reinforced battery box welded onto cover plate to withstand harsh forklift environment
- On/Off switch to conserve battery life, with green LED
- Zigbee™ connection from scale to indicator
- Battery life, minimum 24 hours constant use with only 8 hours to fully charge
- Includes two lithium ion smart batteries and charger

**Factory Recommendations**

- Rice Lake recommends using Zebra RW 220 or RW 420 portable thermal printer
- When installing a forklift scale on an electric forklift, static discharge protection must be installed on the forklift
- When installing a forklift scale, OSHA requires the end user to de-rate the lift capacity of the forklift
- Compatible with most Class II and Class III forklift attachments, consult factory
- Power conditioner installed when used on electric forklift scales

**SPECIFICATIONS****Scale Capacity:**

- Class II: 5,000 lb x 5 lb NTEP approved
- 5,000 lb x 1 lb non type approved
- Class III: 8,000 lb x 5 lb NTEP type approved

**Scale Power:**

Supplied by indicator through coiled interface cable

**Scale Material/Finish:**

Painted Mild Steel

**420 Plus Display:**

0.8 in (20 mm), 6-digit Super Red  
Light Emitting Diode (LED),  
7-segment digits

**420 Power - DC:**

Line voltages: 10-60VDC DC input  
Power consumption: 0.75A Max  
Fused at 5.0A

**420 Status Annunciators:**

Designators for: center of zero, stand still, gross, net,  
lb, kg, tare

**420 Operating Temperature:**

Legal: 14°F to 104°F (-10°C to 40°C)  
Industrial: 14°F to 122°F (-10°C to 50°C)

**Warranty:**

Two-year limited warranty

**Approvals:**

NTEP CC 06-074 (5,000 lb only) per H-44 at  
1,000 divisions

# **CLS-420 Wireless Version** Cargo Lift Scale

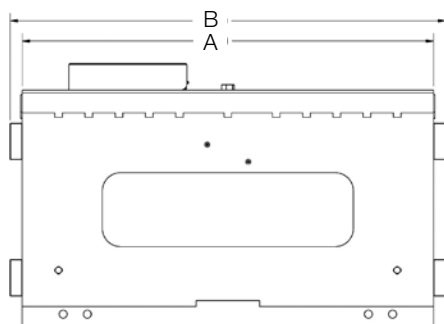

Front view

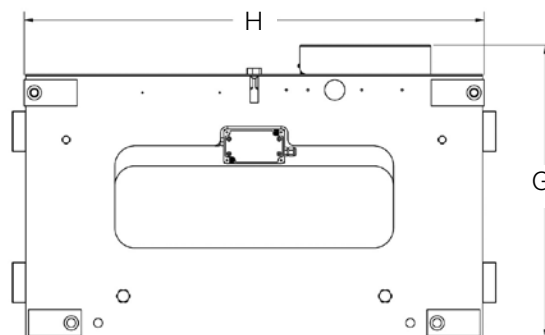

Rear view

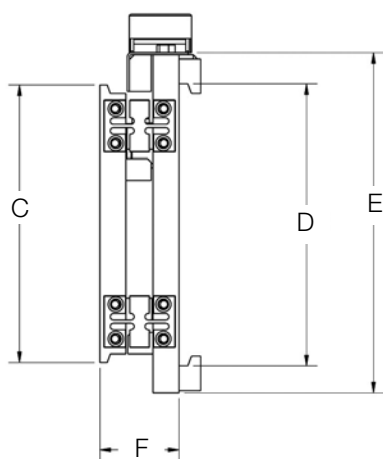

Side view

## **CLS DIMENSIONS**

### **28 in, 5000 lb**

A	28	E	19.50
B	30	F	4.49
C	16	G	21.80
D	16.29	H	28.24

### **34 in, 5000 lb**

A	34	E	19.50
B	36	F	4.49
C	16	G	21.80
D	16.29	H	34.24

### **19.50 in, 8000 lb 4.49**

A	38	E	24.50
B	40	F	6.04
C	20	G	26.68
D	20.15	H	38

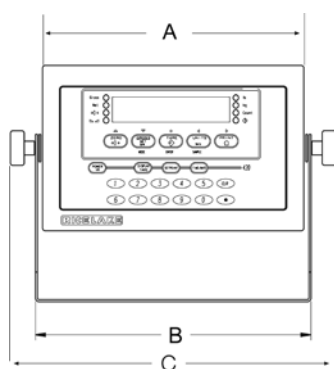

420 Plus Side view

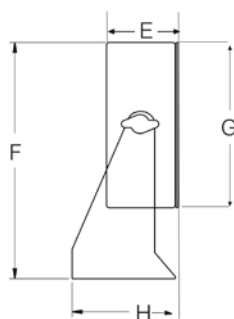

## **420 PLUS DIMENSIONS**

A	9.50 in (24 mm)	F	8.57 in (217 mm)
B	10.02 in (254 mm)	G	6.00 in (152 mm)
C	11.80 in (299 mm)	H	3.25 in (82 mm)
E	3.12 in (79 mm)		3.0 in (76.2 mm)

**CLS-420 Wireless Version** Cargo Lift Scale**PART NUMBER/PRICE**

PART #	SIZE, CAPACITY	FORKLIFT COMPATIBILITY	WEIGHT	PRICE
<b>CLS Forklift Scale, 420 Wireless Zigbee™ Version</b>				
111034	5,000 x 5 lb NTEP approved	28 in W, Class II 16 in forklift carriage (30 in W with flexures)	524 lb	Consult
130823	5,000 x 5 lb NTEP approved	34 in W, Class II 16 in forklift carriage (36 in W with flexures)	539 lb	Consult
151506*	8,000 x 5 lb Non Legal for Trade	38 in W, Class III 20 in forklift carriage (40 in W with flexures)	1144 lb	Consult

\*Non-NTEP

**OPTIONS/ACCESSORIES**

PART #	DESCRIPTION	PRICE
112986	Wireless LAN card 802.11 B/G, requires factory installation	Consult
Consult	Bluetooth module, factory installed	Consult
<b>Replacement Parts</b>		
96196	Custom load cell box wrench	Consult
98413	CLS 420i replacement indicator	Consult
96252	Coiled cable (j-box to indicator), black	Consult
96915	Power cable assembly with power fuse cable	Consult
130129	Power fuse cable assembly	Consult
96198	RL 20000 FLS load cell 5K 1.5 mv/v 350 ohm (for use with 121014)	Consult
121014	iQUBE™ J-box assembly, (for use with 96198), Class II	Consult
121366	iQUBE J-box assembly, (for use with 96198), Class III	Consult
125543	RL20000 FLS load cell 5K 1.5 mv/v 350 ohm (for use with 130826) with automotive quick disconnects	Consult
130826	iQUBE j-box assembly (for use with 125543), Class II with automotive quick disconnects	Consult
132960	iQUBE j-box assembly (for use with 125543), Class III with automotive quick disconnects	Consult
98289	Wireless indicator j-box (upgrade wired to wireless)	Consult
152479	Zigbee™ wireless battery box (upgrade wired to wireless), 28 in	Consult
126534	Zigbee™ wireless battery box (upgrade wired to wireless), 34 in	Consult
131864	Zigbee™ wireless battery box (upgrade wired to wireless), 38 in	Consult
96343	Battery, forklift lithium ion	Consult
<b>Manuals</b>		
96483	CLS-420 installation manual	Consult
96484	CLS-420 operator card	Consult